

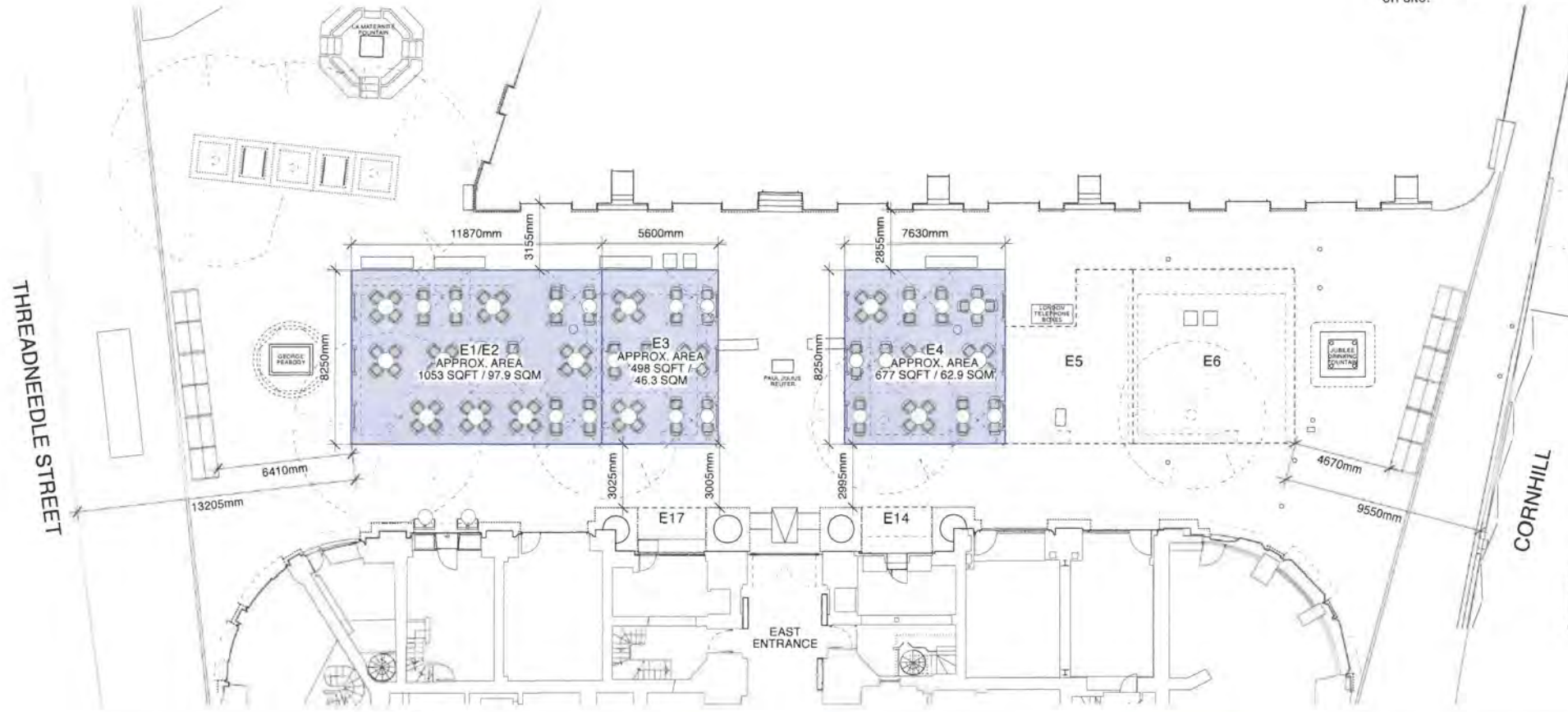

NOTE: This plan is derived from unverified record information. All areas and dimensions to be checked on site.

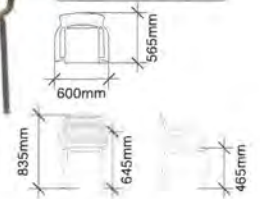

NARDI DOGA ARMCHAIR; COLOUR: TABACCO. STACKABLE. MATERIAL: UNIFORMLY COLOURED FIBERGLASS POLYPROPYLENE RESINS WITH UV ADDITIVES; CUSHION IN COLOUR LINO.



NARDI PIANO LAMINATO TABLE TOP; 2 PERSON 700MM DIAMETER, 4 PERSON 800MM DIAMETER; COLOUR: ANTRACITE; MATERIAL: LAMINATE HPL.



NARDI BASE FRASCA MINI FOLDING TABLE BASE; COLOUR: VERNIATO-TABACCO; STACKABLE HORIZONTALLY; ADJUSTABLE HEIGHT FEET; MATERIAL: COATED ALUMINIUM.

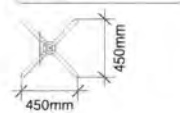

PROPOSED UNIT DIVIDERS; YELLOW-GOLD SCREEN PRINT ROYAL EXCHANGE LOGO; DIVIDER POLES MATERIAL: POWDER-COATED ALUMINIUM; DIVIDER SCREENS MATERIAL: FABRIC IN COLOUR HUNTER GREEN.

	E1+E2	E3	E4	Total
Chairs and cushions	48	24	34	106
2-Person 700mm table tops	8	6	7	21
4-Person 800mm table tops	8	3	5	16
Table bases	16	9	12	37
Parasols	4	3	3	10
Divider Poles				30
Divider Screens				15

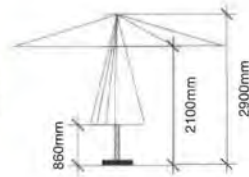
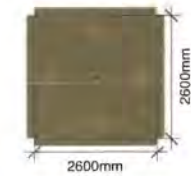

2600MM SQUARE PARASOLS; BAMBRELLA HURRICANE ALUMINIUM PARASOL; YELLOW-GOLD SCREEN PRINT ROYAL EXCHANGE LOGO.



B mc 11/06/24 Drawing updated following Client comments
 A mc 03/06/24 Drawing updated for Master Licence

HFM
 Architecture and Project Management

© HADSON FEW MCHTUSCH ARCHITECTS LTD. Please do not scale from this drawing. Dimensions are to be checked on site, errors and omissions are to be reported to the Architect - if in doubt, please get in touch.

CLIENT: Ardent
 PROJECT: Royal Exchange

LEASE
 DRAWING TITLE: Lanes Seating Lease Plan

SCALE: 1:200
 DATE: 28/05/24
 SIZE: A3
 BY: mrc
 PROJECT: 3466
 DRAWING NO.: LA-L102
 REV: B