

- Notes:**
1. No information to be scaled from this drawing.
 2. Works shall comply with the current City of London Specification for Highway works.
 3. This drawing is to be read in conjunction with all relevant drawings
 4. The Contractor will be held responsible for any damage caused to private highways and privately owned street furniture.

- KEY**
- 300 x 200 flame textured silver grey granite kerb
 - 300 x 200 flame textured silver grey granite kerb (filleted)
 - 150 x 300 flame textured silver grey granite kerb
 - Proposed 63mm thick (600mm x 300mm) Scoutmoor Yorkstone Channel
 - Proposed 63mm thick (600mm x varied) Scoutmoor Yorkstone paving
 - Proposed 63mm thick (300mm x 200mm) Scoutmoor Yorkstone sets
 - Proposed 25mm thick mastic surfacing (footway specification)
 - Proposed 6mm DBM surfacing (temporary surface until the remaining highway works are underway)
 - Proposed HRA carriageway surfacing
 - Proposed 63mm thick (400mm x 400mm) Scoutmoor tactile paving
 - Proposed 63mm thick (400mm x 400mm) Scoutmoor corduroy paving
 - Proposed 1.5m x 1.5m removable island from Rosehill Highways
 - Proposed cycle stand
 - Proposed sign / sign & post
 - Proposed CoL C3 bollard & RS140 NAL socket
 - Proposed TfL traffic signal pole
 - Proposed 450 x 450mm cycle friendly gully
 - Proposed KS150 drainage channel
 - Proposed street tree

TITLE:

King William Street Pedestrian Priority Scheme

TITLE:

General Arrangement Plan

CLIENT:

**HIGHWAY DESIGN
AND CONSTRUCTION**

DEPARTMENT OF THE BUILT ENVIRONMENT
PO BOX 270
GUILDHALL
LONDON
EC2P 2EJ
TEL: 020 7606 3030



**CITY
OF
LONDON**

Sheet:	SHEET 1 of 3	THIS MAP IS REPRODUCED FROM ORDNANCE SURVEY MATERIAL WITH THE PERMISSION OF ORDNANCE SURVEY ON BEHALF OF THE CONTROLLER OF HER MAJESTY'S STATIONERY OFFICE © CROWN COPYRIGHT 2006. ALL RIGHTS RESERVED. UNAUTHORISED REPRODUCTION INFRINGES CROWN COPYRIGHT AND MAY LEAD TO PROSECUTION OR CIVIL PROCEEDINGS. CITY OF LONDON 100023243 2008.
Date:	Jun 2024	
Designed by:	SR	
Checked by:	BM / DL	
Scale & Drawing Size:	1:200@A1	
Revision:		Drawing No: 100/16800457/KW/GA

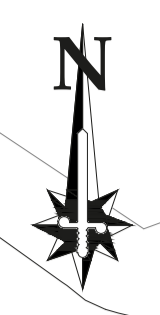
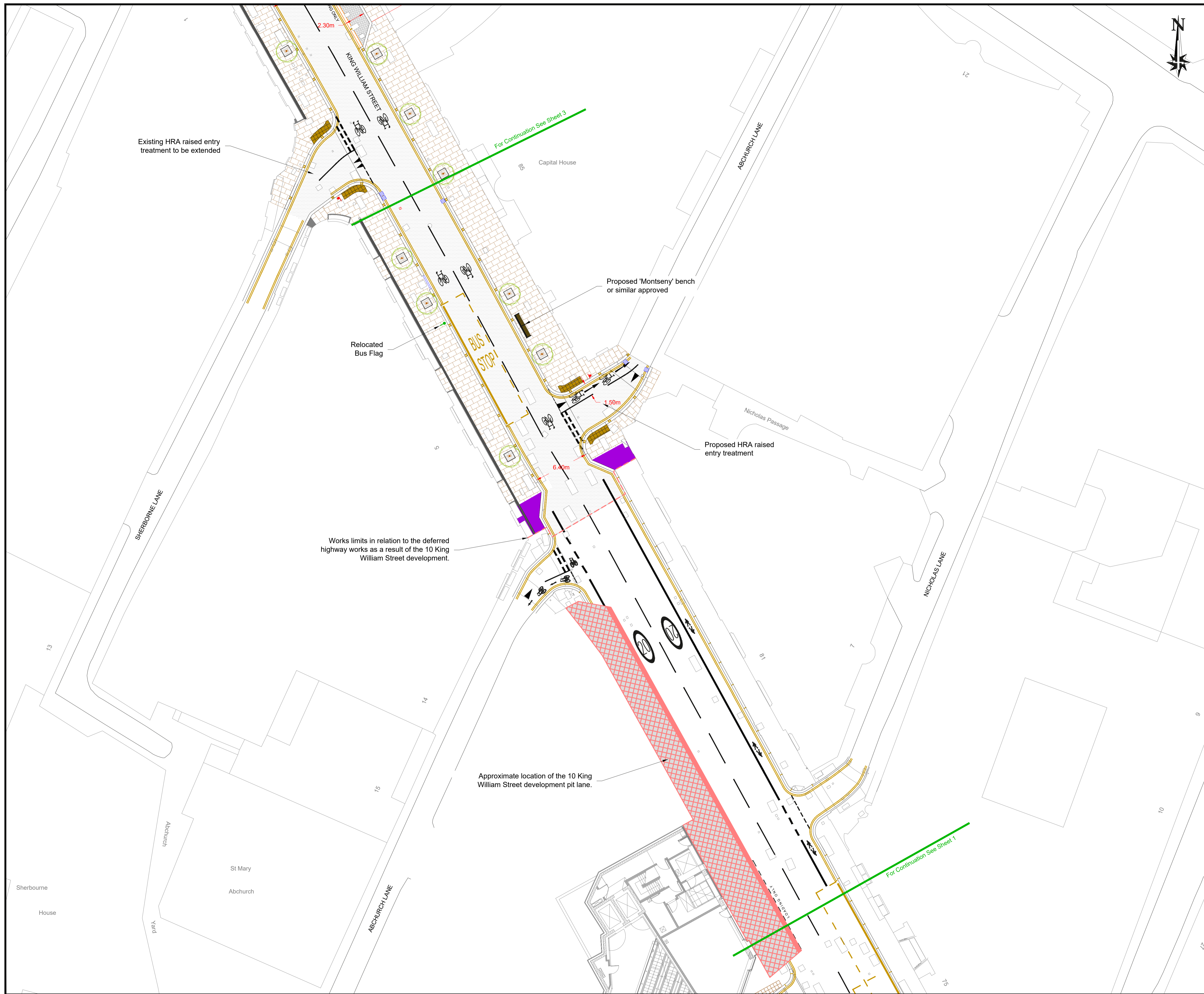

- Notes:**
1. No information to be scaled from this drawing.
 2. Works shall comply with the current City of London Specification for Highway works.
 3. This drawing is to be read in conjunction with all relevant drawings
 4. The Contractor will be held responsible for any damage caused to private highways and privately owned street furniture.

- KEY**
- 300 x 200 flame textured silver grey granite kerb
 - 300 x 200 flame textured silver grey granite kerb (filleted)
 - 150 x 300 flame textured silver grey granite kerb
 - Proposed 63mm thick (600mm x 300mm) Scoutmoor Yorkstone Channel
 - Proposed 63mm thick (600mm x varied) Scoutmoor Yorkstone paving
 - Proposed 63mm thick (300mm x 200mm) Scoutmoor Yorkstone sets
 - Proposed 25mm thick mastic surfacing (footway specification)
 - Proposed 6mm DBM surfacing (temporary surface until the remaining highway works are underway)
 - Proposed HRA carriageway surfacing
 - Proposed 63mm thick (400mm x 400mm) Scoutmoor tactile paving
 - Proposed 63mm thick (400mm x 400mm) Scoutmoor corduroy paving
 - Proposed 1.5m x 1.5m removable island from Rosehill Highways
 - Proposed cycle stand
 - Proposed sign / sign & post
 - Proposed CoL C3 bollard & RS140 NAL socket
 - Proposed TfL traffic signal pole
 - Proposed 450 x 450mm cycle friendly gully
 - Proposed KS150 drainage channel
 - Proposed street tree

TITLE:

**King William Street
Pedestrian Priority
Scheme**

TITLE:

General Arrangement Plan

CLIENT:

**HIGHWAY DESIGN
AND CONSTRUCTION**

DEPARTMENT OF THE BUILT ENVIRONMENT
PO BOX 270
GUILDHALL
LONDON
EC2P 2EJ
TEL: 020 7606 3030

Sheet: SHEET 2 of 3	THIS MAP IS REPRODUCED FROM ORDNANCE SURVEY MATERIAL WITH THE PERMISSION OF ORDNANCE SURVEY ON BEHALF OF THE CONTROLLER OF HER MAJESTY'S STATIONERY OFFICE © CROWN COPYRIGHT 2006. ALL RIGHTS RESERVED. UNAUTHORISED REPRODUCTION INFRINGES CROWN COPYRIGHT AND MAY LEAD TO PROSECUTION OR CIVIL PROCEEDINGS. CITY OF LONDON 100023243 2008.
Date: Jun 2024	
Designed by: SR	
Checked by: BM / DL	
Scale & Drawing Size: 1:200@A1	
Revision:	Drawing No: 100/16800457/KW/GA

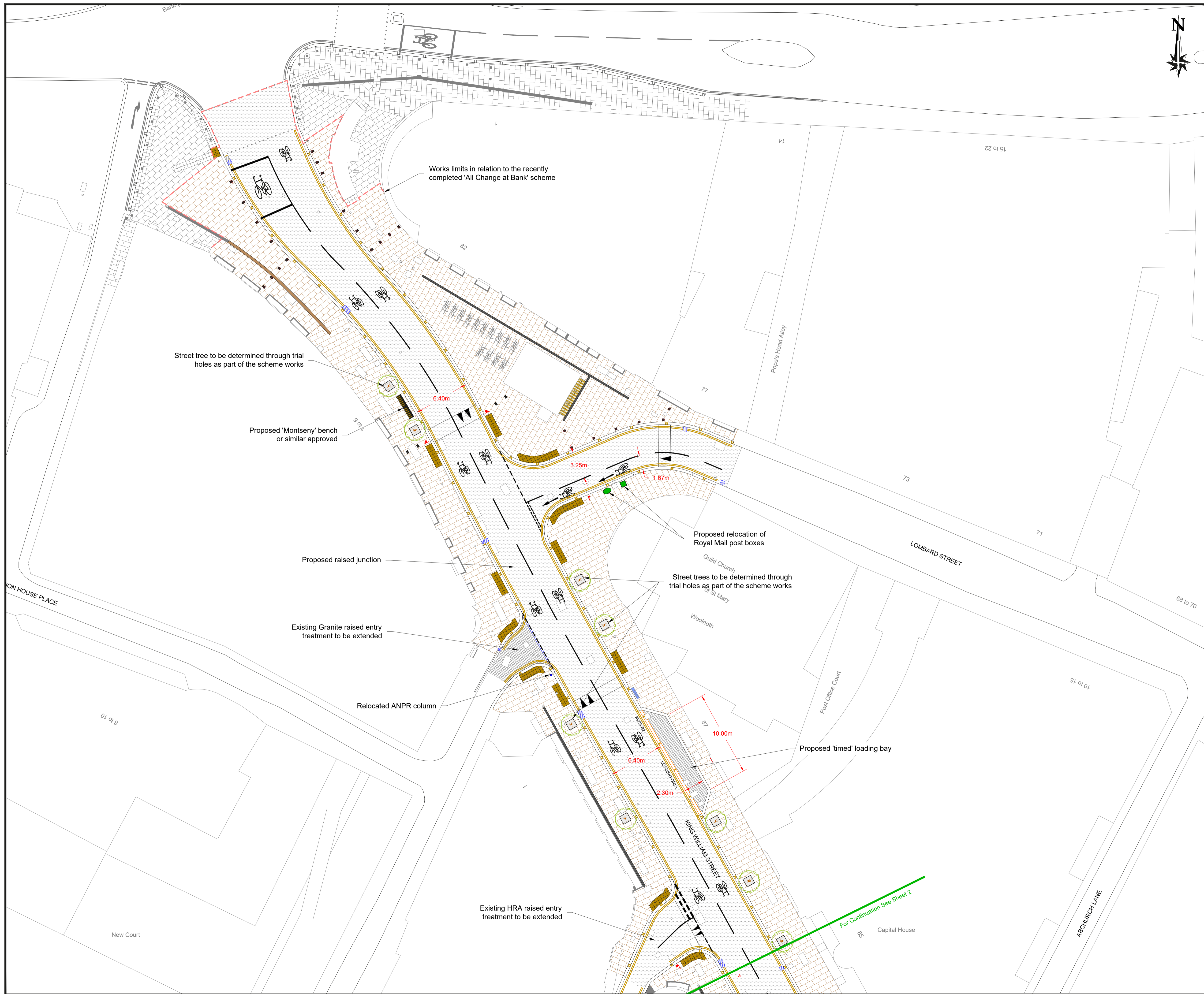

- Notes:**
1. No information to be scaled from this drawing.
 2. Works shall comply with the current City of London Specification for Highway works.
 3. This drawing is to be read in conjunction with all relevant drawings
 4. The Contractor will be held responsible for any damage caused to private highways and privately owned street furniture.

- KEY**
- 300 x 200 flame textured silver grey granite kerb
 - 300 x 200 flame textured silver grey granite kerb (filleted)
 - 150 x 300 flame textured silver grey granite kerb
 - Proposed 63mm thick (600mm x 300mm) Scoutmoor Yorkstone Channel
 - Proposed 63mm thick (600mm x varied) Scoutmoor Yorkstone paving
 - Proposed 63mm thick (300mm x 200mm) Scoutmoor Yorkstone sets
 - Proposed 150mm thick (150mm x 300mm) two-colour mix Granite sets
 - Proposed 25mm thick mastic surfacing (footway specification)
 - Proposed HRA carriageway surfacing
 - Proposed 63mm thick (400mm x 400mm) Scoutmoor tactile paving
 - Proposed 63mm thick (400mm x 400mm) Scoutmoor corduroy paving
 - Proposed 1.5m x 1.5m removable island from Rosehill Highways
 - Proposed cycle stand
 - Proposed sign / sign & post
 - Proposed CoL C3 bollard & RS140 NAL socket
 - Proposed TfL traffic signal pole
 - Proposed 450 x 450mm cycle friendly gully
 - Proposed KS150 drainage channel
 - Proposed street tree

TITLE:

**King William Street
Pedestrian Priority
Scheme**

TITLE:

General Arrangement Plan

CLIENT:

**HIGHWAY DESIGN
AND CONSTRUCTION**

DEPARTMENT OF THE BUILT ENVIRONMENT
PO BOX 270
GUILDHALL
LONDON
EC2P 2EJ
TEL: 020 7606 3030

<p>Sheet: SHEET 3 of 3</p> <p>Date: Jun 2024</p> <p>Designed by: SR</p> <p>Checked by: BM / DL</p> <p>Scale & Drawing Size: 1:200@A1</p>	<p>THIS MAP IS REPRODUCED FROM ORDNANCE SURVEY MATERIAL WITH THE PERMISSION OF ORDNANCE SURVEY ON BEHALF OF THE CONTROLLER OF HER MAJESTY'S STATIONERY OFFICE © CROWN COPYRIGHT 2006. ALL RIGHTS RESERVED. UNAUTHORISED REPRODUCTION INFRINGES CROWN COPYRIGHT AND MAY LEAD TO PROSECUTION OR CIVIL PROCEEDINGS. CITY OF LONDON 100023243 2008.</p> <p>Revision: Drawing No: 100/16800457/KW/GA</p>
--	---