

- Notes:**
1. No information to be scaled from this drawing.
  2. Works shall comply with the current City of London Specification for Highway works.
  3. This drawing is to be read in conjunction with all relevant drawings
  4. The Contractor will be held responsible for any damage caused to private highways and privately owned street furniture.

- KEY**
- 300 x 200 flame textured silver grey granite kerb
  - 300 x 200 flame textured silver grey granite kerb (filleted)
  - 150 x 300 flame textured silver grey granite kerb
  - Proposed 63mm thick (600mm x 300mm) Scoutmoor Yorkstone Channel
  - Proposed 63mm thick (600mm x varied) Scoutmoor Yorkstone paving
  - Proposed 63mm thick (300mm x 200mm) Scoutmoor Yorkstone sets
  - Proposed 25mm thick mastic surfacing (footway specification)
  - Proposed 6mm DBM surfacing (temporary surface until the remaining highway works are underway)
  - Proposed HRA carriageway surfacing
  - Proposed Contar Resin Surface in 'Ash'
  - Proposed 63mm thick (400mm x 400mm) Scoutmoor tactile paving
  - Proposed 63mm thick (400mm x 400mm) Scoutmoor corduroy paving
  - Proposed cycle stand
  - Proposed sign / sign & post
  - Proposed CoL C3 bollard & RS140 NAL socket
  - Proposed TfL traffic signal pole
  - Proposed 450 x 450mm cycle friendly gully
  - Proposed KS150 drainage channel
  - Proposed street tree

**TITLE:**

## King William Street Pedestrian Priority Scheme

**TITLE:**

## General Arrangement Plan

**CLIENT:**

**HIGHWAY DESIGN  
AND CONSTRUCTION**

DEPARTMENT OF THE BUILT ENVIRONMENT  
PO BOX 270  
GUILDHALL  
LONDON  
EC2P 2EJ  
TEL: 020 7606 3030

<p>Sheet: SHEET 1 of 3</p> <p>Date: Aug 2024</p> <p>Designed by: SR</p> <p>Checked by: BM / DL</p> <p>Scale &amp; Drawing Size: 1:200@A1</p>	<p>THIS MAP IS REPRODUCED FROM ORDNANCE SURVEY MATERIAL WITH THE PERMISSION OF ORDNANCE SURVEY ON BEHALF OF THE CONTROLLER OF HER MAJESTY'S STATIONERY OFFICE © CROWN COPYRIGHT 2006. ALL RIGHTS RESERVED. UNAUTHORISED REPRODUCTION INFRINGES CROWN COPYRIGHT AND MAY LEAD TO PROSECUTION OR CIVIL PROCEEDINGS. CITY OF LONDON 100023243 2006.</p> <p>Revision: A</p> <p>Drawing No: 100/16800457/KW/GA</p>
--	--



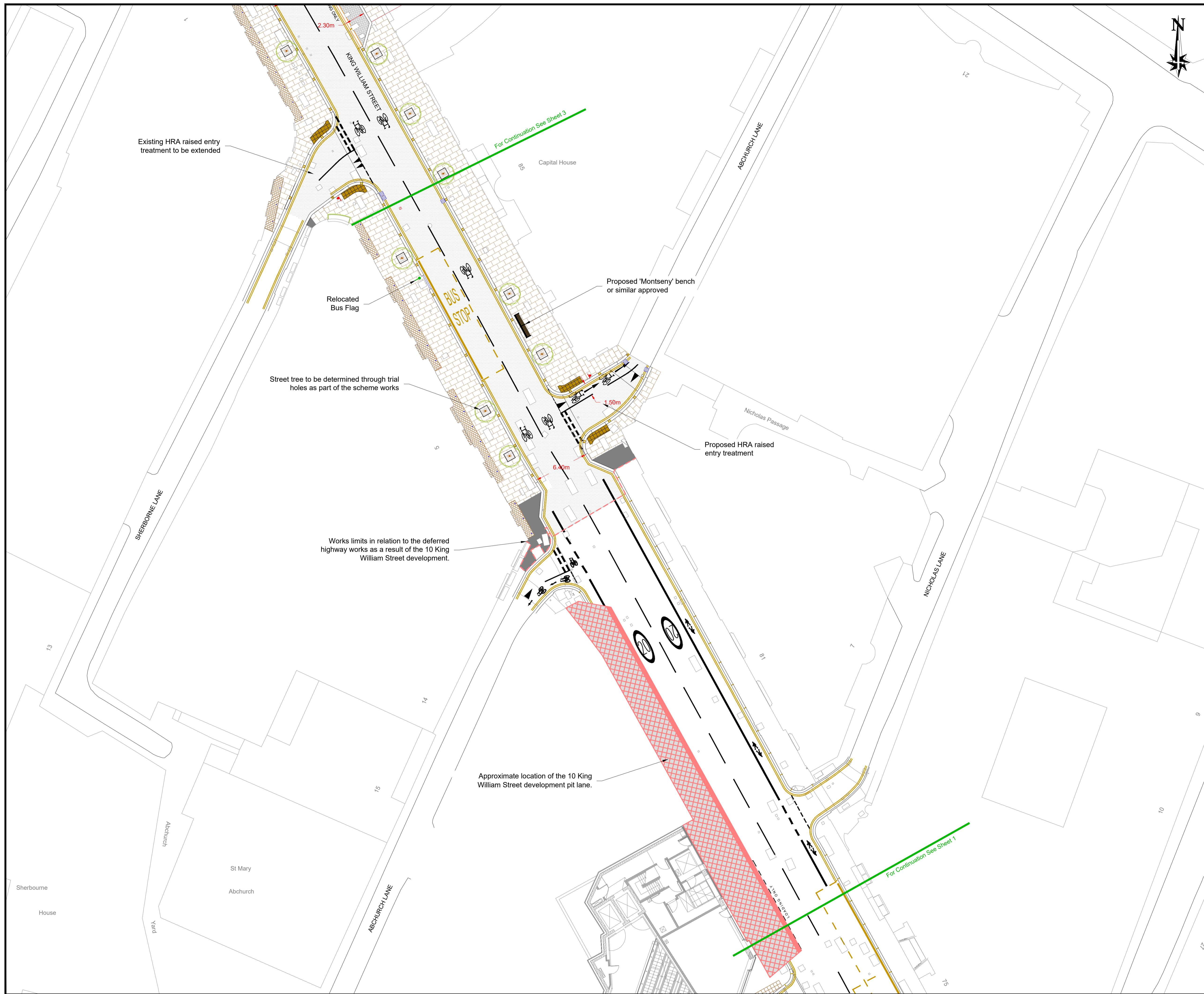

- Notes:**
1. No information to be scaled from this drawing.
  2. Works shall comply with the current City of London Specification for Highway works.
  3. This drawing is to be read in conjunction with all relevant drawings
  4. The Contractor will be held responsible for any damage caused to private highways and privately owned street furniture.

**KEY**

	300 x 200 flame textured silver grey granite kerb
	300 x 200 flame textured silver grey granite kerb (filleted)
	150 x 300 flame textured silver grey granite kerb
	Proposed 63mm thick (600mm x 300mm) Scoutmoor Yorkstone Channel
	Proposed 63mm thick (600mm x varied) Scoutmoor Yorkstone paving
	Proposed 63mm thick (300mm x 200mm) Scoutmoor Yorkstone sets
	Proposed 25mm thick mastic surfacing (footway specification)
	Proposed 6mm DBM surfacing (temporary surface until the remaining highway works are underway)
	Proposed HRA carriageway surfacing
	Proposed Contar Resin Surface in 'Ash'
	Proposed 63mm thick (400mm x 400mm) Scoutmoor tactile paving
	Proposed 63mm thick (400mm x 400mm) Scoutmoor corduroy paving
	Proposed cycle stand
	Proposed sign / sign & post
	Proposed CoL C3 bollard & RS140 NAL socket
	Proposed TfL traffic signal pole
	Proposed 450 x 450mm cycle friendly gully
	Proposed KS150 drainage channel
	Proposed street tree

**TITLE:**

**King William Street  
Pedestrian Priority  
Scheme**

**TITLE:**

**General Arrangement Plan**

**CLIENT:**

**HIGHWAY DESIGN  
AND CONSTRUCTION**

DEPARTMENT OF THE BUILT ENVIRONMENT  
PO BOX 270  
GUILDHALL  
LONDON  
EC2P 2EJ  
TEL: 020 7606 3030

**Sheet:** SHEET 2 of 3

**Date:** Aug 2024

**Designed by:** SR

**Checked by:** BM / DL

**Scale & Drawing Size:** 1:200@A1

**Revision:** A

**Drawing No:** 100/16800457/KW/GA

HIS MAP IS REPRODUCED FROM ORDNANCE SURVEY MATERIAL WITH THE PERMISSION OF ORDNANCE SURVEY ON BEHALF OF THE CONTROLLER OF HER MAJESTY'S STATIONERY OFFICE © CROWN COPYRIGHT 2006. ALL RIGHTS RESERVED. UNAUTHORISED REPRODUCTION INFRINGES CROWN COPYRIGHT AND MAY LEAD TO PROSECUTION OR CIVIL PROCEEDINGS. CITY OF LONDON 100023243 2006.



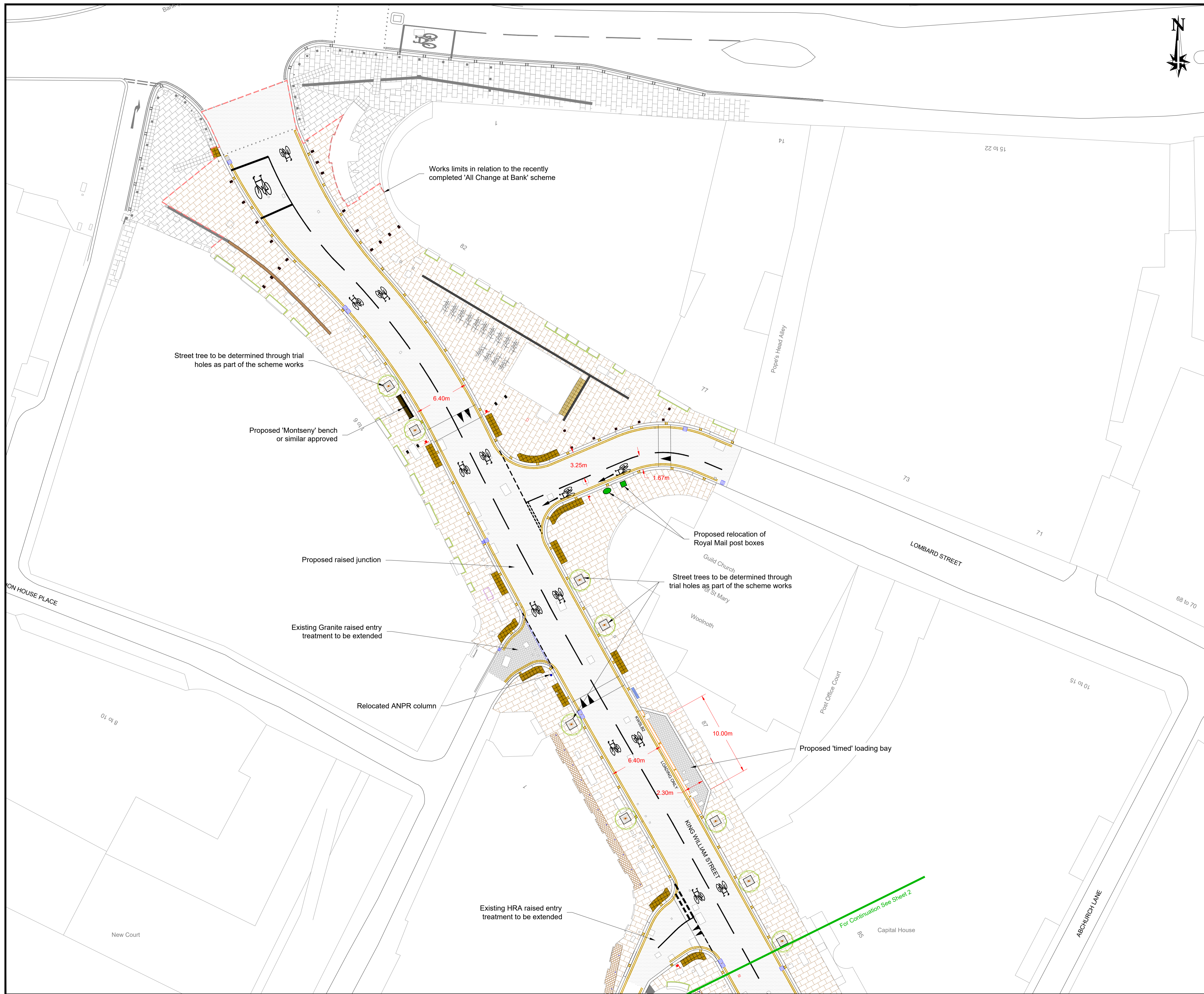

- Notes:**
1. No information to be scaled from this drawing.
  2. Works shall comply with the current City of London Specification for Highway works.
  3. This drawing is to be read in conjunction with all relevant drawings
  4. The Contractor will be held responsible for any damage caused to private highways and privately owned street furniture.

- KEY**
- 300 x 200 flame textured silver grey granite kerb
  - 300 x 200 flame textured silver grey granite kerb (filleted)
  - 150 x 300 flame textured silver grey granite kerb
  - Proposed 63mm thick (600mm x 300mm) Scoutmoor Yorkstone Channel
  - Proposed 63mm thick (600mm x varied) Scoutmoor Yorkstone paving
  - Proposed 63mm thick (300mm x 200mm) Scoutmoor Yorkstone sets
  - Proposed 25mm thick mastic surfacing (footway specification)
  - Proposed 6mm DBM surfacing (temporary surface until the remaining highway works are underway)
  - Proposed HRA carriageway surfacing
  - Proposed Contar Resin Surface in 'Ash'
  - Proposed 63mm thick (400mm x 400mm) Scoutmoor tactile paving
  - Proposed 63mm thick (400mm x 400mm) Scoutmoor corduroy paving
  - Proposed cycle stand
  - Proposed sign / sign & post
  - Proposed CoL C3 bollard & RS140 NAL socket
  - Proposed TfL traffic signal pole
  - Proposed 450 x 450mm cycle friendly gully
  - Proposed KS150 drainage channel
  - Proposed street tree

TITLE:

## King William Street Pedestrian Priority Scheme

TITLE:

## General Arrangement Plan

CLIENT:

**HIGHWAY DESIGN  
AND CONSTRUCTION**

DEPARTMENT OF THE BUILT ENVIRONMENT  
PO BOX 270  
GUILDHALL  
LONDON  
EC2P 2EJ  
TEL: 020 7606 3030



**CITY  
OF  
LONDON**

Sheet:	SHEET 3 of 3	<small>HIS MAP IS REPRODUCED FROM ORDNANCE SURVEY MATERIAL WITH THE PERMISSION OF ORDNANCE SURVEY ON BEHALF OF THE CONTROLLER OF HER MAJESTY'S STATIONERY OFFICE © CROWN COPYRIGHT 2006. ALL RIGHTS RESERVED. UNAUTHORISED REPRODUCTION INFRINGES CROWN COPYRIGHT AND MAY LEAD TO PROSECUTION OR CIVIL PROCEEDINGS. CITY OF LONDON 100023243 2008.</small>
Date:	Aug 2024	
Designed by:	SR	
Checked by:	BM / DL	
Scale & Drawing Size:	1:200@A1	
Revision:	A	Drawing No: <b>100/16800457/KW/GA</b>